

702#-1-C

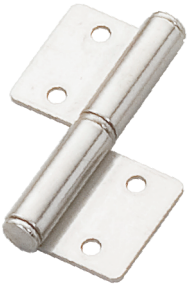

702#-2-C



702#-3-C



702#-1-C(B)



1702#-1-B  
702#-1-B

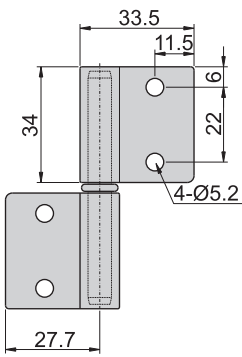

1702#-2-B  
702#-2-B

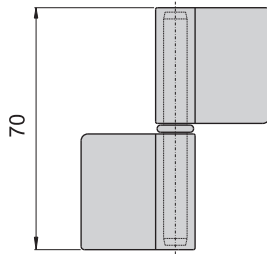

材 質	1702#---不鏽鋼(SUS 304)
	702#---鐵
表面處理	702# 葉子---材料本質
	702#-1(B)---砂面黑色耐刮面 心軸---電鍍

鉸  
鏈

1702#-3-C  
702#-3-C

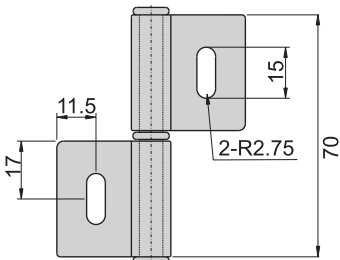

702#-1-D(B)

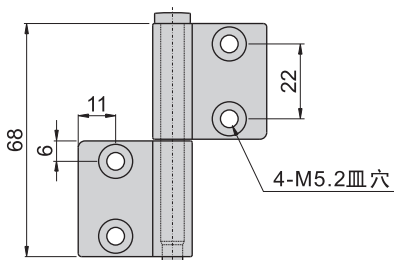

1702# T=2m/m  
702# T=2.3m/m

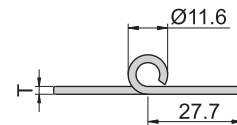

1702#、702# 用心軸

單邊固定

1702#-B  
702#-B

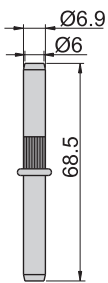

1702#-C  
702#-C

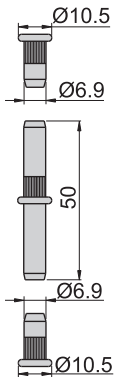

1702#-D  
702#-D

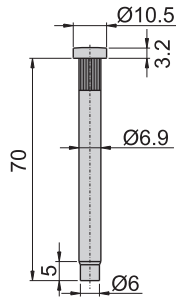

雙邊活動

1702#-B1  
702#-B1

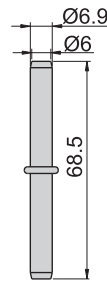

1702#-C1  
702#-C1

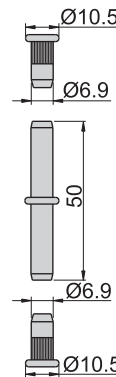

1702#-D1  
702#-D1

