

JKA-1045-A



JKA-45-B(S)



JKA-19-A(S)



JKA-1019-B



JKA-1045-A
JKA-45-A

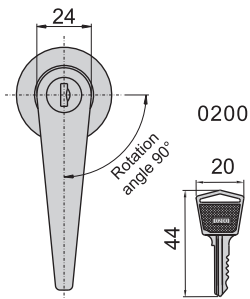

JKA-1045-B
JKA-45-B

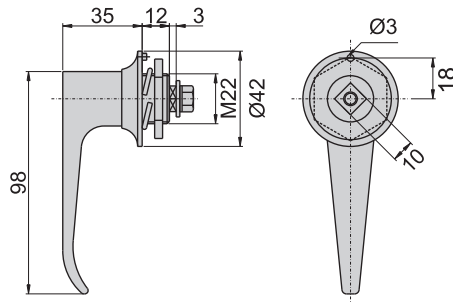
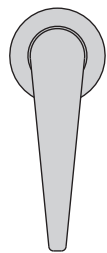

順時針開孔尺寸圖

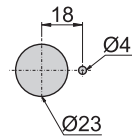

逆時針開孔尺寸圖



JKA-1019-A
JKA-19-A

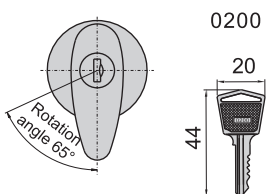

JKA-1019-B
JKA-19-B

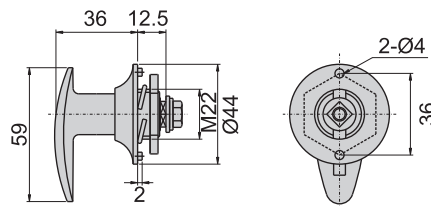
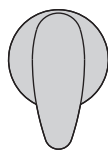

順時針開孔尺寸圖

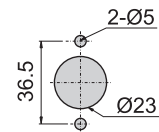

逆時針開孔尺寸圖

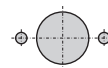

材 質	JKA-1045, JKA-1019 不鏽鋼 (SUS 316)
	JKA-45, JKA-19 鋅合金 (ZDC)
表面處理	JKA-1045, JKA-1019 鏡面研磨
	JKA-45, JKA-19(S) 鍍鉻-光面, (G) 鍍香檳色
適用門扇	JKA-1045 / JKA-45---400×300
	JKA-1019 / JKA-19---400×250