

CPA-406-19-1



CPA-406-19-2



CPA-406-19-11



CPA-406-19-22

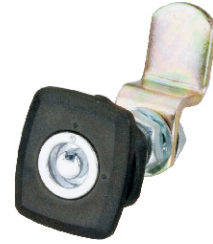

CPA-406-19-1

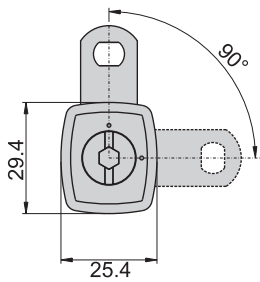

CPA-406-19-2

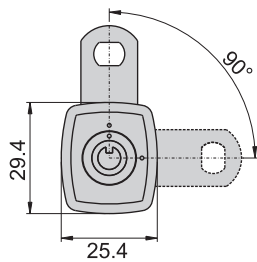

附取手參考圖

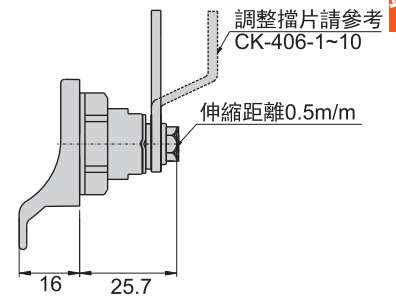
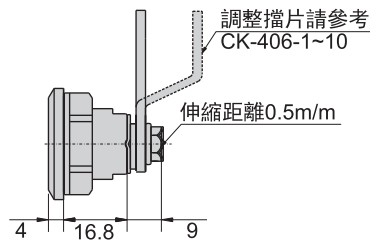

CPA-406-19-11

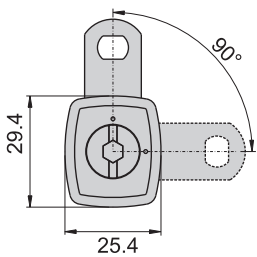

CPA-406-19-22

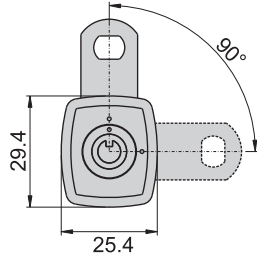

附取手參考圖

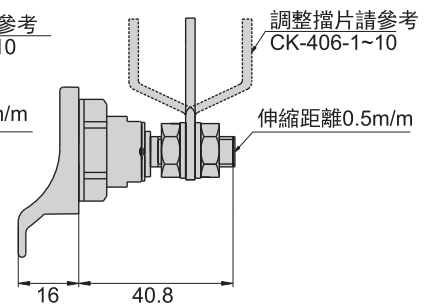
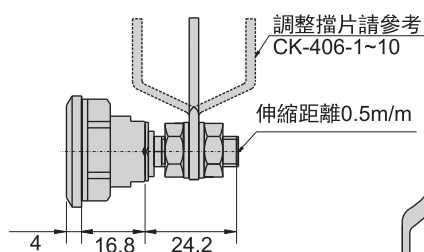

開孔尺寸圖

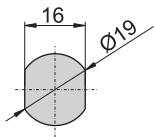

材 質	外殼、螺母---PA6-GF30 (黑色), 轉心---鋅合金 (ZDC)
表面處理	轉心---鍍鉻
特 徵	彈簧伸縮式鎖頭
適用門扇	200×150
備 註	另可選購搭配下列相關產品:
	NL-406-Ø32取手, 擋片CK-406-1至CK-406-10
	CPA-406-19-1/11內六角系列---鑰匙可選擇塑料 (CPA-406-18-1-PH)或鋅料 (CPA-406-18-1-H)
	CPA-406-19-2/22內圓孔系列---鑰匙可選擇鋅料 (CPA-406-18-2-H)